



Emergency

LED Screwless Hinged Emergency Twin Batten | 5ft - 60w | 6ft - 65w | 4000k

Chips Type/Brand:	Samsung SMD LED Chips Boke Driver
-------------------	-----------------------------------

Wattage:	5ft: 60w 6ft: 65w
----------	----------------------

Lumens:	5ft: 120lm/w 6ft: 130lm/w
---------	------------------------------

Colour Temperature:	4000K
---------------------	-------

Dimmable	No
----------	----

Beam Angle:	120°
-------------	------

Voltage input:	220-240V
----------------	----------

IP Rating:	IP20
------------	------

Lifespan:	50,000 Hours
-----------	--------------

CRI:	>80
------	-----

IK Rating:	IKo8
------------	------

Working Temperature:	-20°C-+45°C
----------------------	-------------

Power Factor:	>0.9
---------------	------





Emergency

LED Screwless Hinged Emergency Twin Batten | 5ft - 60w | 6ft - 65w | 4000k

Emergency Power:

1.5W-2W Power

Emergency Duration:

3 Hours

Warranty:

3-year Guarantee

Dimensions/Cut out:

5ft: 1470mm x 61mm x 71mm, fixing
distance 1265mm

6ft: 1734mm x 61mm x 71mm, fixing
distance 1529mm

Certificates:

RoHs CE

Material:

White Steel Housing

Application:

Hospitals, Schools, Colleges,
Universities, Offices,
hallways, entrances and most indoor
areas.



Emergency



LED Screwless Hinged Emergency Twin Batten | 5ft - 60w | 6ft - 65w | 4000k

Dimensions

5FT

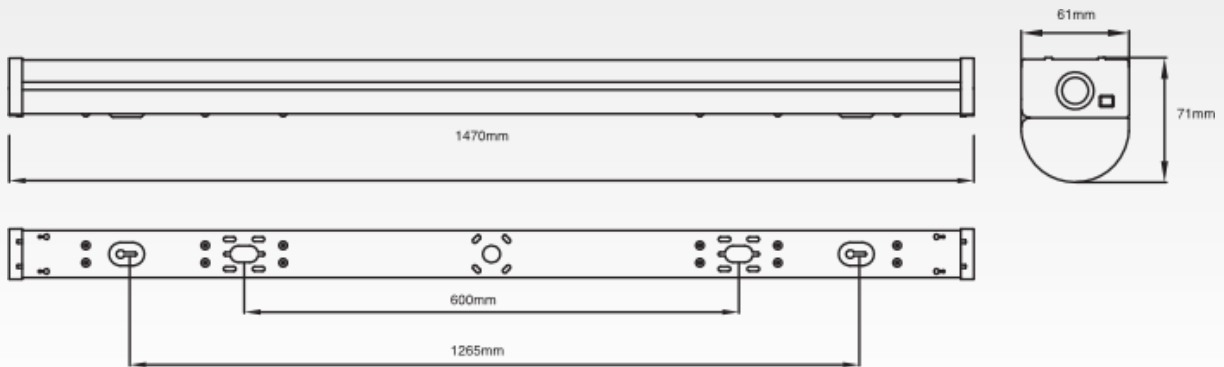

6FT

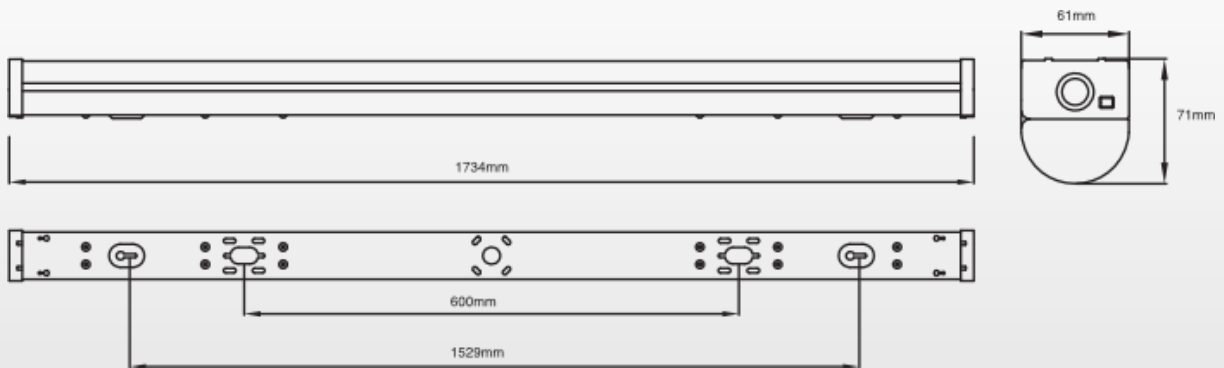



Emergency

LED Screwless Hinged Emergency Twin Batten | 5ft - 60w | 6ft - 65w | 4000k

Spectral Distribution

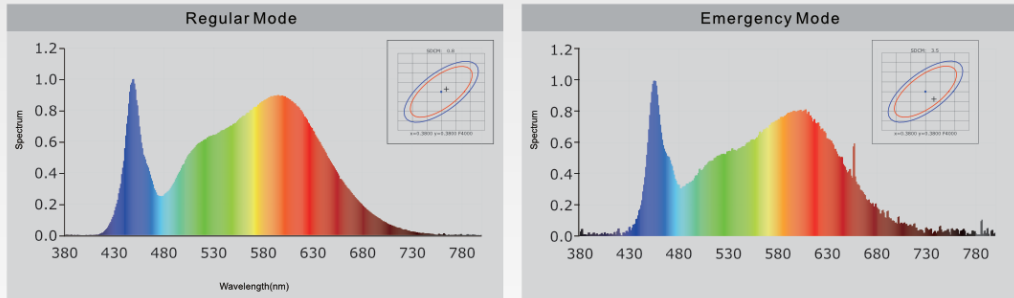

Photometric Diagram

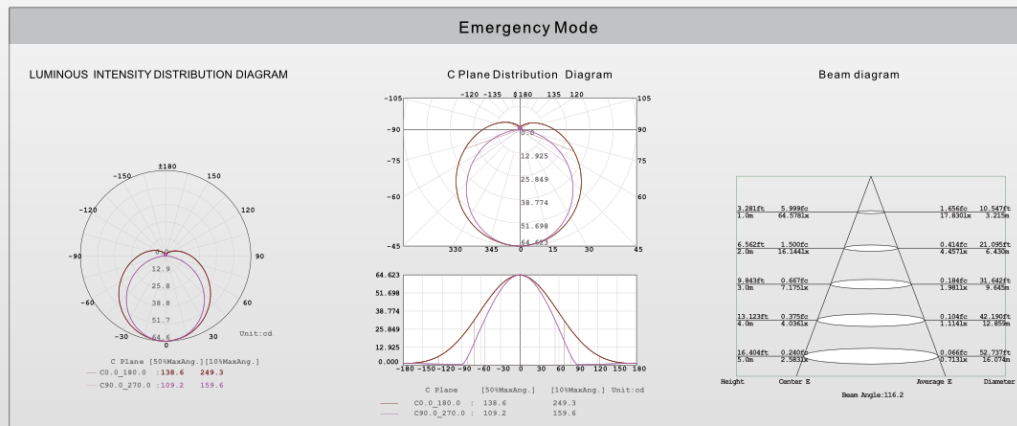
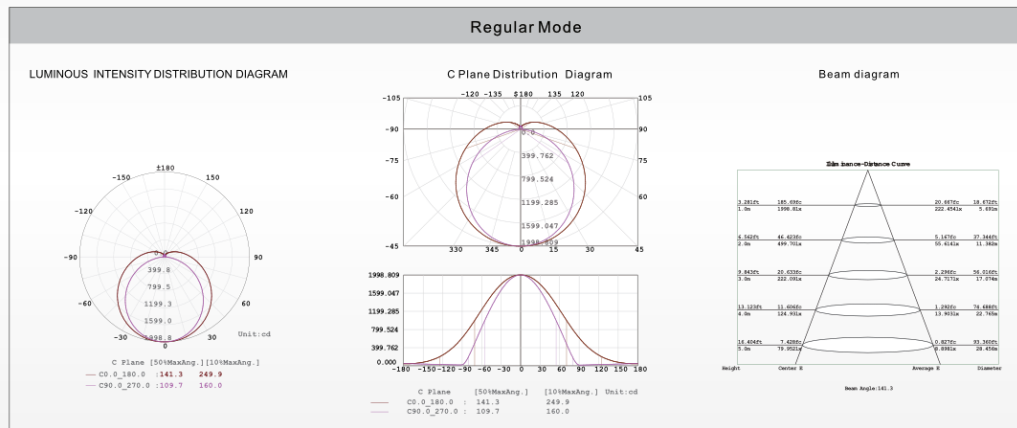



Emergency

LED Screwless Hinged Emergency Twin Batten | 5ft - 60w | 6ft - 65w | 4000k

Polar Diagram Comparison

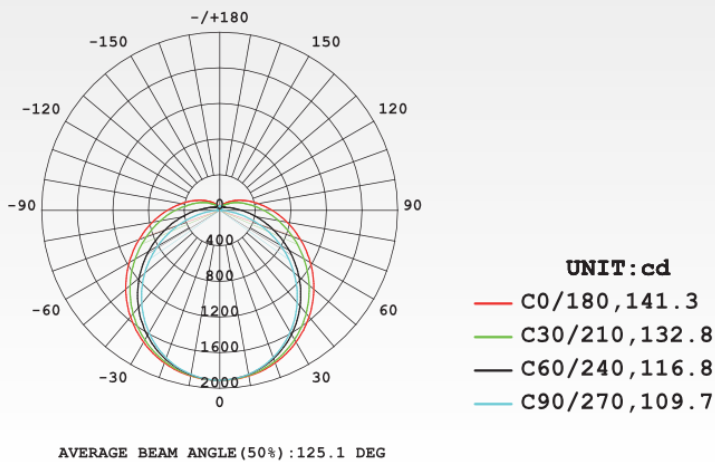

Average Lumen Maintenance and Chromaticity Shift VS. Time

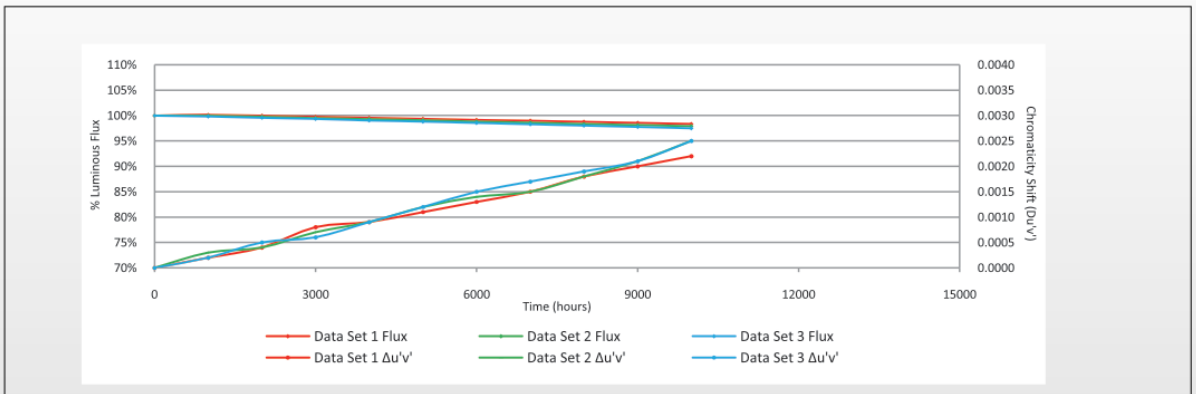

Emergency



LED Screwless Hinged Emergency Twin Batten | 5ft - 60w | 6ft - 65w | 4000k

Installation

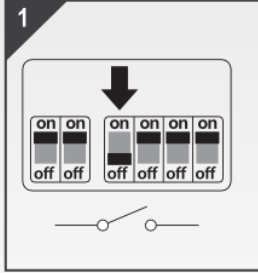

Switch OFF at mains supply before installing

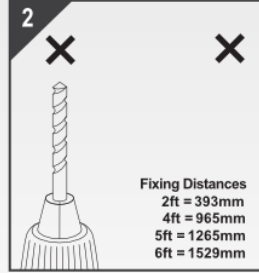

Drill hole to the required distance and install plugs

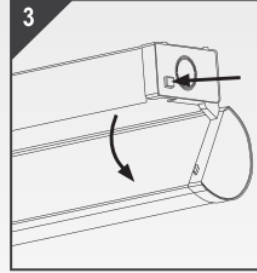

Push button on end-cap and pull open casing

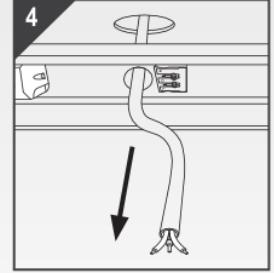

Pull cable from ceiling through hole in batten

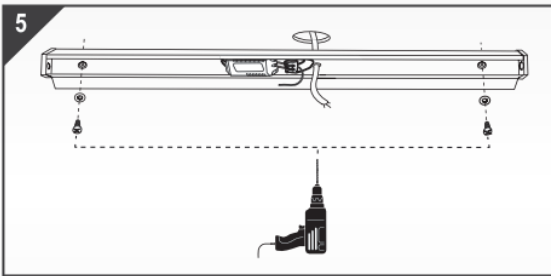

Drill screws into previously installed plugs

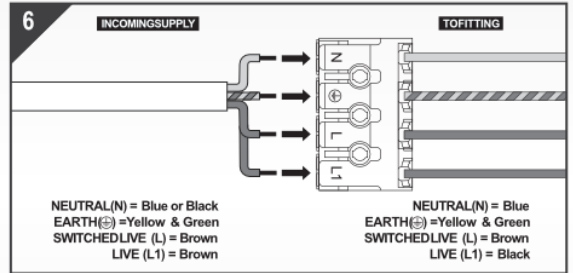

Pushdown the terminal, insert correct supply (as above) into terminal block, for the emergency unit to work correctly please ensure that an uninterrupted permanent live feed is present and is connected directly to the (L1) "Permanent Live" terminal of the connector block. Release the push fit terminal to secure.

Note: Please ensure there are no switches, PIR Set in the permanent live feed, as switching of the emergency pack will reduce the battery's life considerably.

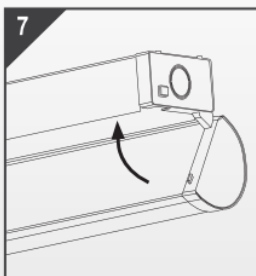

Close casing ensuring it clicks into place

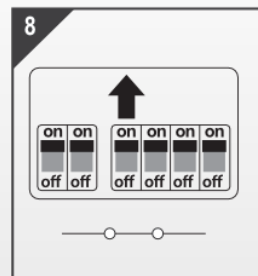

Return power. Switch ON at main supply



Emergency



**LED Screwless Hinged
Emergency Twin Batten |
5ft - 60w | 6ft - 65w | 4000k**



Unit 6, Northfield Way, Newton Aycliffe, County Durham, DL5 6EJ | 01388 814089